

Site Section A-A Scale 1:500

- LEGEND**
- Site boundary: (Area 0.35 acres) —
 - Storm pipe: ---
 - Proposed storm manhole: □ smh
 - Proposed storm aj: □ saj
 - Foul pipe: ---
 - Proposed foul manhole: ○ fmh
 - Proposed foul aj: ○ faj
 - Proposed water main from mains: --- WS
 - Proposed back planting to hedge: ~
 - Existing ground level: ---
 - 150mm thick concrete base on hardcore supporting prefabricated 2.4m x 1.8m metal shed:

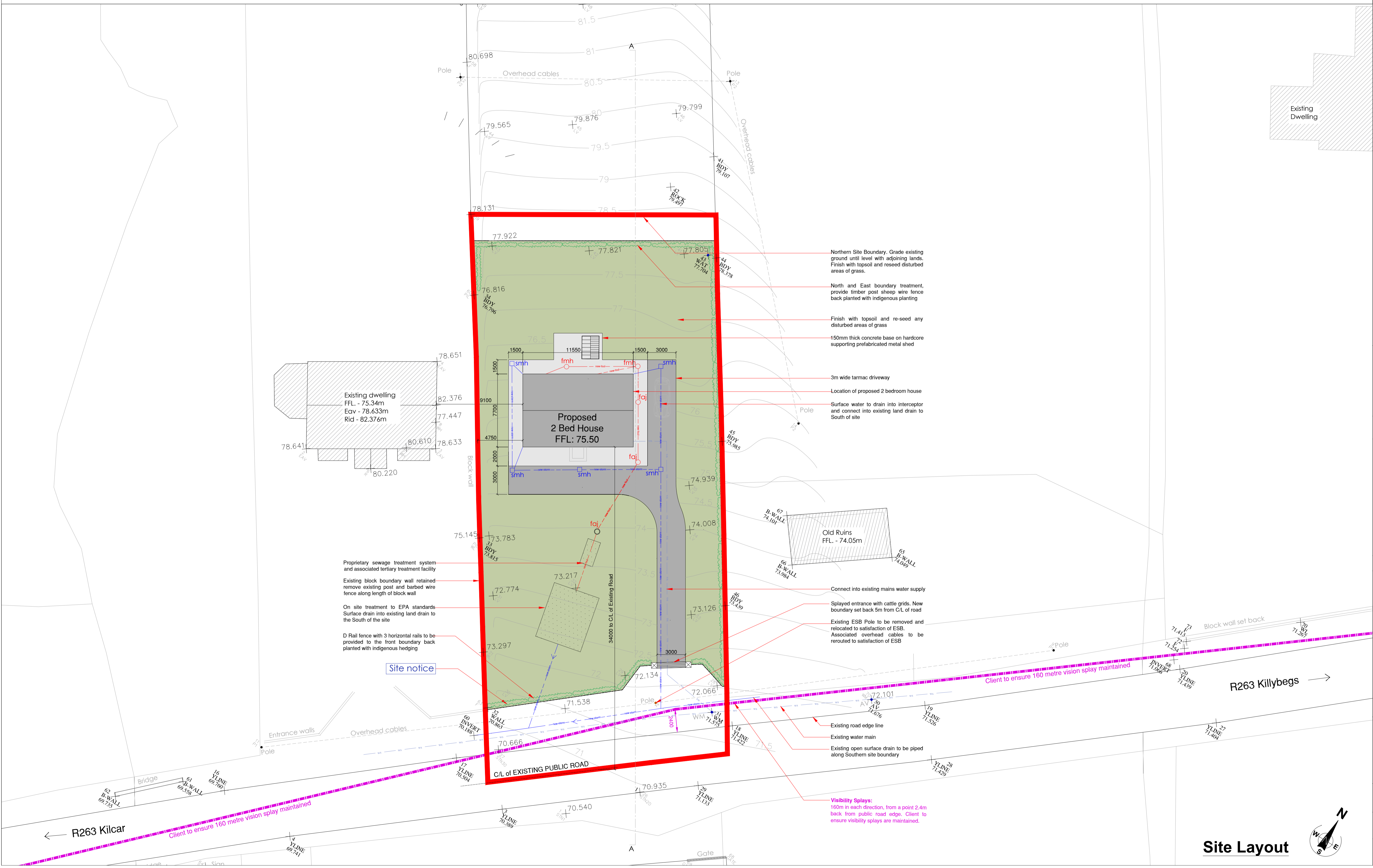

- Hard Landscaping**
New kerbed driveway with concrete apron to house, Driveway to be compacted crushed stone material with tarmac finish graded to finished ground level around dwelling & precast concrete kerb
- Soft Landscaping**
All sound trees, shrubs, hedgerows are to be retained excluding planting that is required to be removed to obtain and gain access to site maintain vision lines and construction of dwelling.
- ESB & EIR**
ESB and EIR services to be underground.
- Boundary Treatment**
Provide timber post, sheep wire and hedgerow of broad leaved semi-mature species native to the area planted in double rows staggered along North and East boundaries. (contractor to seek advice from landscaping specialist).
- Front Boundary**
Area between road and entire front boundary to be dug out to a minimum depth of 450mm and replaced with hardcore and compacted crushed stone. The set back area is to be graded to the existing road levels, falling away from the road towards the site at 1:60. Front boundary fence to be D rail fence with 3 no. horizontal rails to be provided back planted with indigenous hedging in double rows staggered along boundary.
- GENERAL INFORMATION:**
This drawing is to be read in conjunction with all other tender information provided, i.e. house drawings, standard, civils & structural details booklets, trial hole reports etc etc. Any discrepancies are to be brought to the attention of the D.C.C. Clerk of works.
- A variation of +/- 0.5m to be allowed for in the noted finished floor levels to compensate for any unforeseen ground conditions etc.

Revisions

x	xx	xxx

Rev:	Date:	Details:

Donegal County Council
Architects Office



DCC Tel: 074 91 53900

PART VIII SUBMISSION

Project:
2 Bedroom Single Rural Dwelling at Largymore, Kilcar, Co Donegal

Drawing Title:
Proposed Site Layout

Drawing No: P03

Date: July 2022	Scale: 1:200 @ A1
Drawn by: SMC	Job No: SI 20018

Site Layout

