

Adjoining Building - Scaly Place

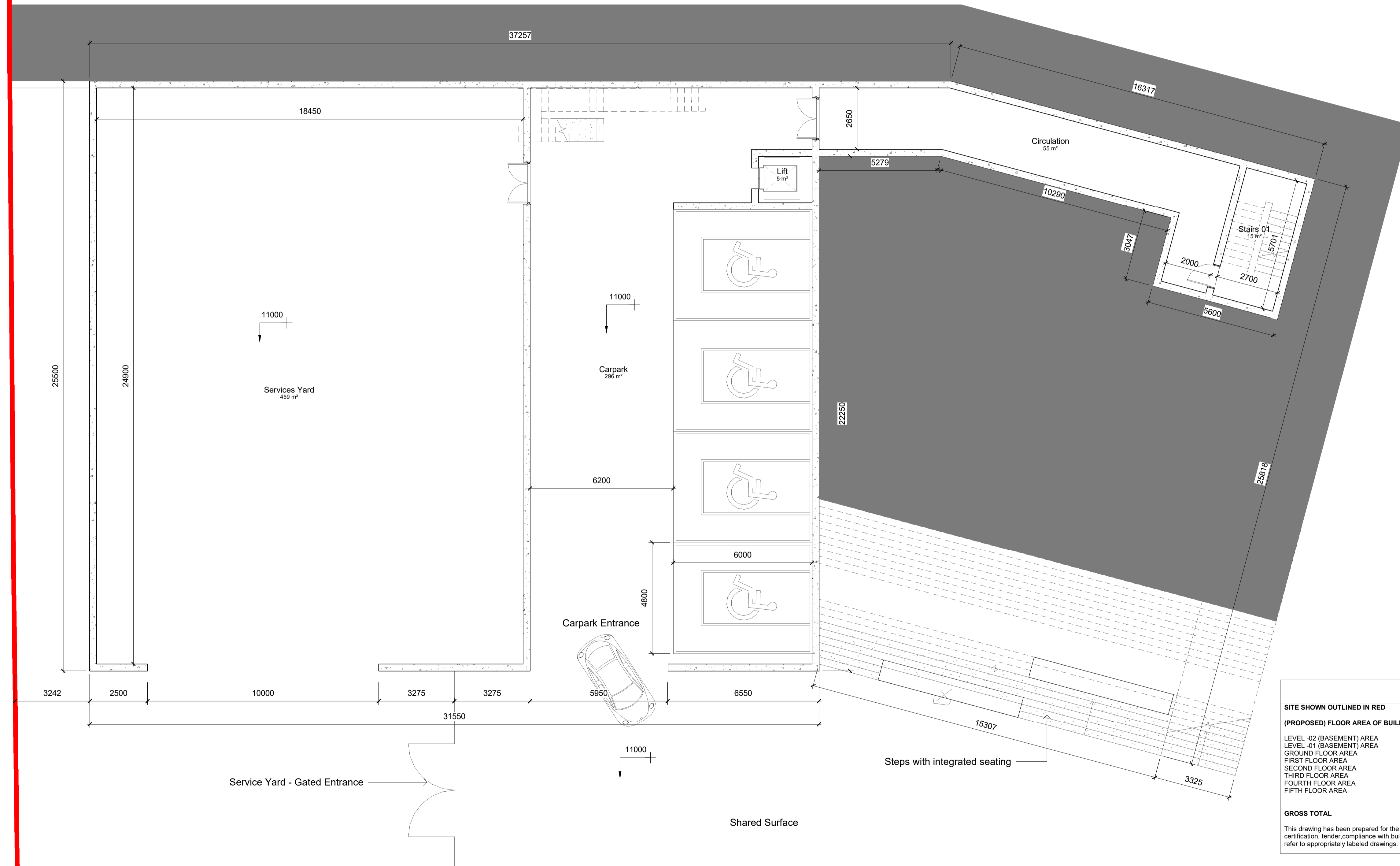
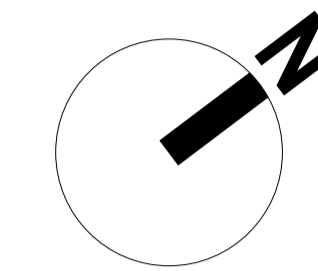

LEGEND		
SITE SHOWN OUTLINED IN RED		
(PROPOSED) FLOOR AREA OF BUILDING	ALPHA	BETA
LEVEL -02 (BASEMENT) AREA	57m <sup>2</sup>	788m <sup>2</sup>
LEVEL -01 (BASEMENT) AREA	128.57m <sup>2</sup>	380.6m <sup>2</sup>
GROUND FLOOR AREA	338m <sup>2</sup>	742.7m <sup>2</sup>
FIRST FLOOR AREA	347.7m <sup>2</sup>	724m <sup>2</sup>
SECOND FLOOR AREA	380.5m <sup>2</sup>	672m <sup>2</sup>
THIRD FLOOR AREA	346.8m <sup>2</sup>	348.2m <sup>2</sup>
FOURTH FLOOR AREA	27m <sup>2</sup>	305m <sup>2</sup>
FIFTH FLOOR AREA		65m <sup>2</sup>
<b>GROSS TOTAL</b>	<b>1,625.57m<sup>2</sup> (17,491.13ft<sup>2</sup>)</b>	<b>3996.5m<sup>2</sup> (43,000ft<sup>2</sup>)</b>

This drawing has been prepared for the purposes of obtaining planning permission only, for fire certification, tender compliance with building regulations, construction, or any other purpose, please refer to appropriately labeled drawings.

**1001 Level -02**  
1 : 100



Community Development & Planning Services  
Regeneration & Development Team  
Three Rivers Centre, Lifford, Co Donegal  
Tel: (074) 9153900 | Fax: (074) 9141793 | www.donegalcoco.ie  
L. Ward, Director of Community Development & Planning Services



SL	SK	INFO	PL	DD	F&C	D&C	T	C	CPO	SF	O
		Survey									
		Sketch Design									
		Information									
		Planning - Part B									
		Detailed Design									
		Fire Safety Cert.									
		Dis. Acc. Cert.									
		Tender									
		Construction									
		CPO									
		Safety File									
		Other									

Rev	Date	Description	Issued by

Project Title:	Letterkenny 2040 Strategic Urban Regeneration Site - Phase 1	First Issue Date:	15.12.2021	Status:	PL
Location:	Pearse Rd and Ramelton Rd, Letterkenny, Co. Donegal	Drawing No.:	LKSURS/0012	Revision:	/
Drawing Title:	Level -02 (Basement) Floor Plan of Alpha / Beta buildings	Project No.:			
Scale:	As Indicated	Drawn By:	S O'Donnell	Checked By:	J Neils
		Approved By:	S McCauley		



© COPYRIGHT - THIS DRAWING IS PROTECTED BY COPYRIGHT AND IS THE PROPERTY OF DONEGAL COUNTY COUNCIL. IT MAY NOT BE USED, REPRODUCED OR DISCLOSED TO ANYONE WITHOUT THE PRIOR WRITTEN APPROVAL OF DONEGAL COUNTY COUNCIL.